

# nbrseeducation

new south wales teachers' federation auditorium  
presbyterian ladies college arts and technology fitout  
penrith anglican college new school  
shellharbour anglican school new school  
northwest nowra public school  
arndell anglican college new school  
presbyterian ladies college performing arts centre and indoor swimming pool  
tara anglican school for girls junior school development

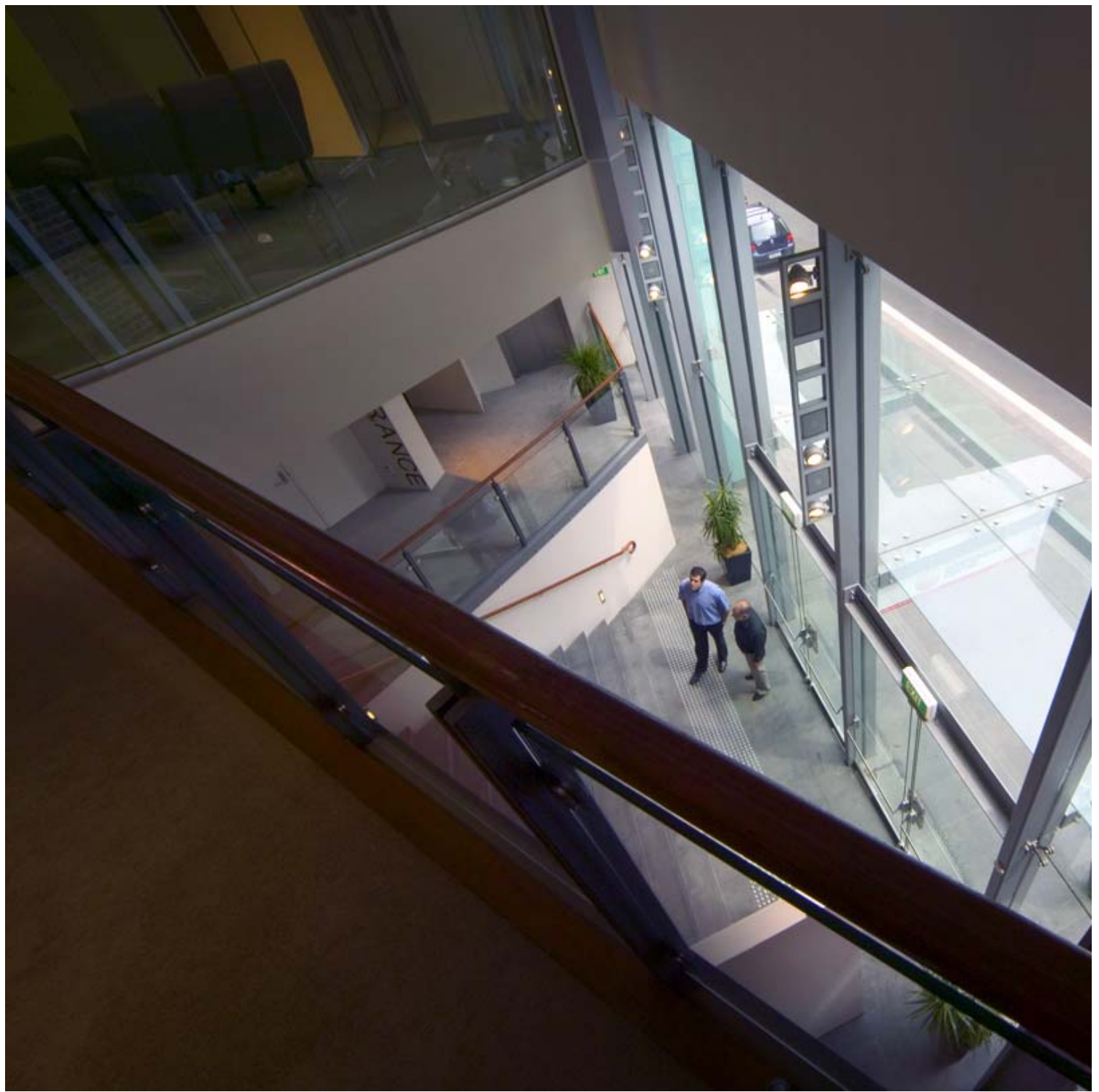

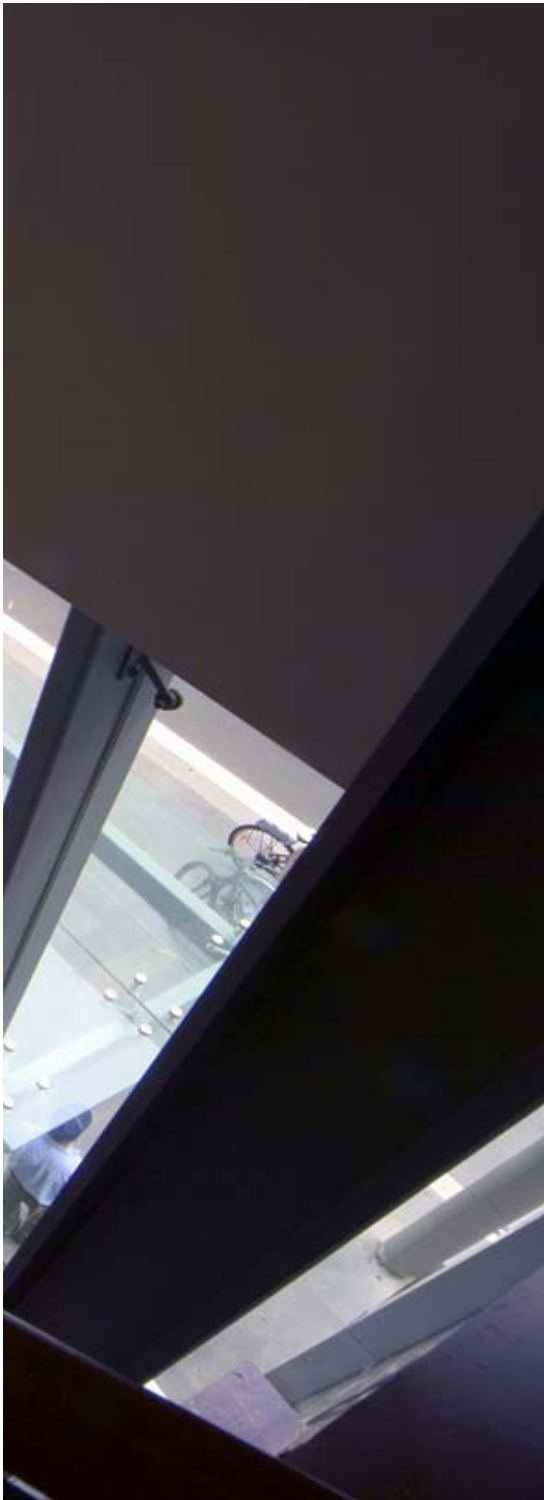

## NEW SOUTH WALES TEACHERS' FEDERATION AUDITORIUM SURRY HILLS NSW

The new meeting place for the NSW Teachers Federation sensitively straddles between an existing heritage building and a new mixed use development. The project incorporates a 450 seat auditorium with attendant entry & foyer, toilets and catering facilities purpose designed to meet the unique interactive parliamentary debating style needs of the Federation.

The site is on the city edge. The entry and foyer spaces welcome attendees from the busy Reservoir Street in Surry Hills leading to dramatic vertical volumes housing playful circulation structures.

The state of the art auditorium is designed for interactive use and seating for 400 in a comfortable, intimate, tiered, fan arrangement. At the upper level of the auditorium there are bridges linking to breakout spaces. Formality and informality connects in an inspiring functional way. The result is a delightful, working facility.



## PRESBYTERIAN LADIES COLLEGE 'THE CROYDON' CROYDON NSW

Occupying a little over Nine Hundred Square Meters of Land the Croydon Hotel, through the work of NBR&P, has been successfully developed into the new Arts and Technology Building for the Presbyterian Ladies College.

The building retains, without apology, clear evidence of its former life as a hotel. The three floors have been developed to house the equivalent in space of ten classrooms. Existing art deco features have been retained and enhanced, and within the buildings walls a workshop-style centre of exciting creativity had emerged.

The adaptation of the building is to be visually understood and appreciated by the students in its finished form. The building had to reflect the creative processes undertaken in its transformation phase, which in turn would compliment and support the activities of the students. Containing Art Studio, Ceramics and 3D Form work spaces, Art Gallery, Woodwork and Metal work areas, and Computer rooms, this versatile building allows students to encounter modern technology in an encouraging environment.



## PENRITH ANGLICAN COLLEGE, PENRITH

This is a K-12 new low fee independent school for the Sydney Anglican Schools Corporation. Located on a prominent site in west Penrith with magnificent views to the Blue Mountains it is unique in providing a majority of its facilities as earth shelter construction. This significantly reduces its visual impact in the semi-rural landscape.

The facilities are primary planned in modules which includes four general purpose learning areas arranged around shared resource facilities and including significant information technology networking.



## SHELLHARBOUR ANGLICAN SCHOOL SHELLHARBOUR NSW

Located on a prominent semi rural sloping green field site, the Shellharbour Anglican School is a double stream K-12 school. The site has spectacular views to the west of the rolling Kiama downs and the Illawarra escarpment.

The design allows for a staged development according to school growth. In the first stages a Kindergarten Block, Primary Modules, Administration Building and Technological and Applied Studies Block have been completed. More facilities will be completed progressively as it grows.

It's a beautiful setting and the design sits comfortably on the slope. The language of the design is steel roof vernacular stepping as the hill rises. The design is purpose driven to allow the flexibility of growth.



## NORTHWEST NOWRA PUBLIC SCHOOL NOWRA NSW

Noel Bell, Ridley Smith & Partners were commissioned by Waller Constructions to provide architectural services for their design development, document and construct tender.

The project was for a total new school on a green fields site adjacent to an environmental sensitive area. The school included new home bases, library, communal hall, canteen & administration facilities. A special wing was also constructed for students with profound disabilities.





ARNDELL ANGLICAN COLLEGE  
WINDSOR NSW

Located in a semi rural context in Oakville near Windsor NSW, Arndell Anglican College is a new K-12 low fee independent school for the Sydney Anglican Schools Corporation. Our specialised education team of architects have been involved in a series of staged projects put together over the years as the school has been growing.

The senior school pioneered the development of the 'Module' concept with each 'Module' dedicated to a stage of learning and houses classrooms around a shared information resource centre. As part of the overall concept, there is a large auditorium seating 500 for use by the school and the community church.

The success of the project has been the strong masterplanning and flexibility to incorporate new ideas. To date 10 stages have been successfully completed including a gymnasium, three secondary modules, two primary modules, an early learning centre for years K – 2, a vocation education training wing, specialised computer learning rooms, a performing arts centre, a library, and sport and playground facilities. The result is a functioning, inspiring school reflecting a strong relationship between architect and the school community.



## PRESBYTERIAN LADIES COLLEGE CROYDON NSW

The project to develop a new performing arts centre and indoor swimming pool at PLC Sydney represented a significant step in improving the facilities of one of Sydney's prominent girl schools.

The indoor swimming pool and performing arts centre replaced a 1927 outdoor swimming pool on the edge of the PLC site. The swimming pool has 8 x 25m lanes and a 12m training pool.

The state of the art performing arts centre which seats 500 has a flexible stage arrangement with an orchestra pit which can be converted to an extension of the stage depending on the type of performance.

The design is flexible and inspiring. Part of the development included the infrastructure to go along with an up to date performing arts centre. Spaces included drama rooms, practice rooms and a green room.



## TARA ANGLICAN SCHOOL FOR GIRLS, JUNIOR SCHOOL PARRAMATTA NSW

The project called for master-planning proposals for the junior school at Tara Anglican School for Girls. Stage 1 of the masterplan included three new classroom buildings, and alterations to the existing infant building.

The new additions are low scale buildings arranged to enclose existing and create new outdoor spaces. They provide contained and secure play areas for the pupils. The plan has a strong diagonal link from the existing central courtyard down through a new lower courtyard which steps again to provide a physical and visual link to the recreation area and native parkland beyond.

The scheme deliberately departs from using existing materials with the aim of creating a more contemporary image for the School. The external walls are in a terra-cotta render finish, with bright coloured composite panels at the gable ends. These panels are designed as a grid of squares with some replaced by square windows to provide light, framed views and a sense of playfulness.